

Ground Floor

FERENS

Sensory Map for new temporary exhibitions

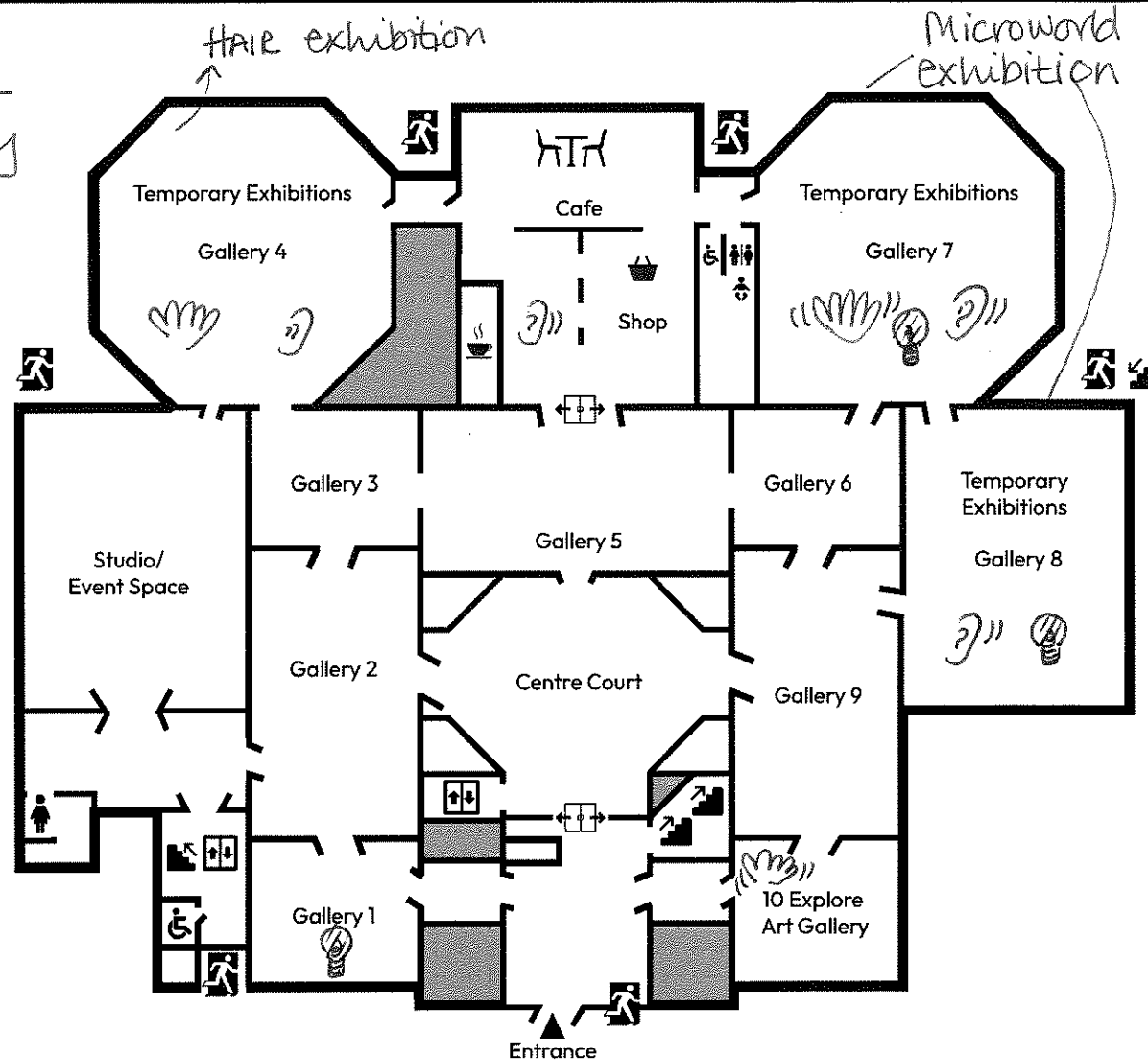

Some things to touch
Interactive/Tactile

noisy
quiet

darker

- 1 Renaissance to Baroque
- 2 Netherlandish
- 3 Eighteenth Century Europe
- 4 Temporary Exhibition
- 5 Edwardian/Victorian
- 6 Early 20th British
- 7 Temporary Exhibition
- 8 Temporary Exhibition
- 9 Modern and Contemporary
- 10 Explore Art Gallery for Under 5s

Key to map

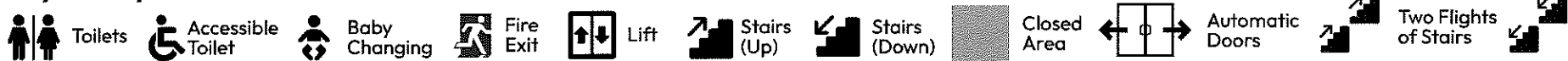

* We are working on a permanent sensory map, this is a practise/draft.